

eLogsPlus PRIME HOURS OF SERVICE



Online
support@e-logplus.com



Support Phone Number
877-843-4770

eLogsPlus PRIME USER MANUAL GUIDE AND DOT REFERENCE CARD

HOW TO SET UP YOUR ELD

1

1
Type Info

Driver ID

Password

Remember Me [Forgot Password?](#)

Login

Click Here **2**

Click Here **3**

3A

1
Type Info

Driver ID

License Number

OR

Expiry Date

Proceed

Click Here **4**

4A

New Password

Confirm Password

Proceed

Click Here **5**

Log in/ Forgot Password

Back to 1

Select Power unit

Power unit Trailers

TLY4
234FDFD3243432234

TLY
LSGSA58M2M2DT0477

TLY2
WALZZ24G2GN157395

TLP
4A3CF34B3PE072958

PR123
POXH7VNV5SWTSLSUZNB

Select Power unit **1**

Click Here **2**

MOVE TO TRAILER SELECTION

SKIP TO ELD CONNECTION

Select Trailer New Trailer

Power unit Trailers

TL today
DODSMTB88EGQDBDIFS

trailer T1
4MB0816R36FVA2KLN

TL1
G3YN2UN78C3764XTV

T01
mri38383838383838

TY
UZ80Z6188888888888

TT
U42345FFDFDFW42345

Select Trailer **1**

Click Here **2**

DONE

SKIP

Truck Selection

1

Click Here to select Co-Driver

Co-Driver

2

Choose any Co-Driver from the list

- Jasprit Singh
- Dilpritt Dhallwal
- Dexter Watts
- Devin Jacobs
- Param Dhillon
- Manprit Kaur
- Lucas Morris
- Manjit Singh
- Ronnie Holt

Auto remove after 34 hour reset

MOVE TO TRAILER SELECTION

Click here to remove selected co-driver

Click Here to auto remove co- driver after 34 Hrs

Co- Driver Selection

5:13 PM

ECM LINKED DEVICES

Click Here **1**

SEARCH DEVICES

5:13 PM

ECM LINKED DEVICES

PT30_C9D8
FC:D3:57:47:C9:D8

PT30_28B4
FC:D3:57:47:C9:D8

Select Device **2**

SEARCH DEVICES

5:13 PM

Device Connected

Engine Status: On

Speed: 0 mph

Odometer(miles): 62869

Engine Hours: 15000

VIN: 234FDFD3243432234

SSID: 3878907823

MOVE TO DASHBOARD

Redirect to Dashboard **3**

Pair ELD & Confirm Connection

DATA TRANSFER DURING ROADSIDE SAFETY INSPECTIONS

To meet FMCSA roadside transfer requirements, the eLogsPlusPrime mobile application uses Option 1—Telematics Transfer Methods, sending data via:

- (i) Wireless Web Services
- (ii) Email

(i) Steps for Wireless Data Transfer via Web Services

- Driver has to click on Roadside Inspection on mobile App.
- Driver has to Select Wireless Web Services Transfer Method.
- Enter comments / inspection code.
- Click on Transfer Button.
- On successful transfer a message will pop up on the screen that indicates wireless web service transfer was successful

(ii) Steps for Wireless Data Transfer Through E-Mail

- Driver has to click on Roadside Inspection on mobile App.
- Driver has to Select Email Transfer Method.
- Enter comments / inspection code.
- Click on Transfer Button
- On successful transfer a message will pop up on the screen that indicates Email transfer was successful

Steps for Reviewing Driver Duty Logs:

- ELD records for the current 24-hour period and the previous 7 consecutive days in electronic format, can be also be viewed from Roadside inspection screen
- For this the user must open the mobile applicaiton and click on Roadside inspection.
- Click on "View Driver Duty Logs"



DATA TRANSFER DURING ROADSIDE SAFETY INSPECTIONS

Wireless Data Transfer via Web Services

Wireless Data Transfer Through E-Mail

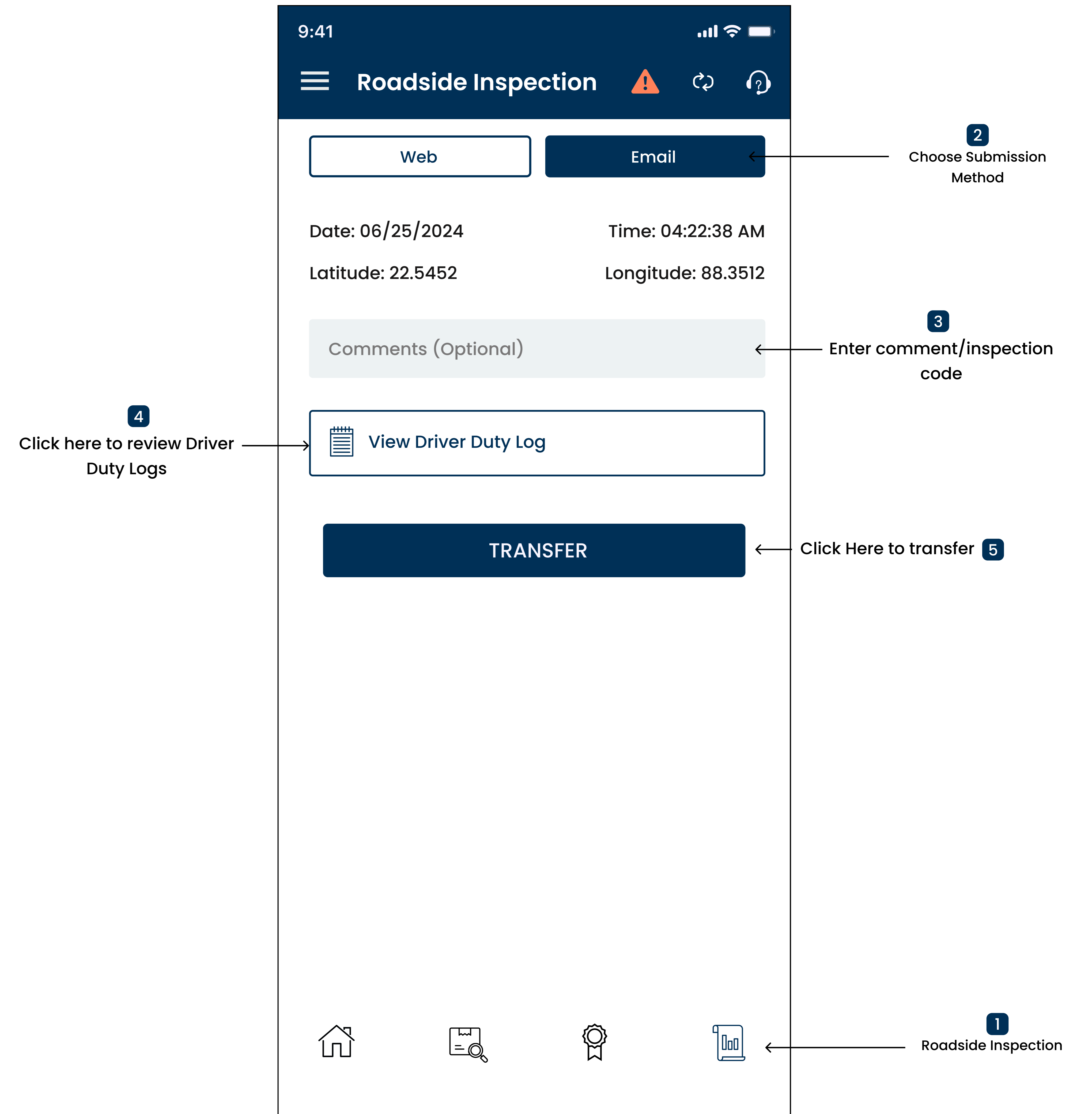
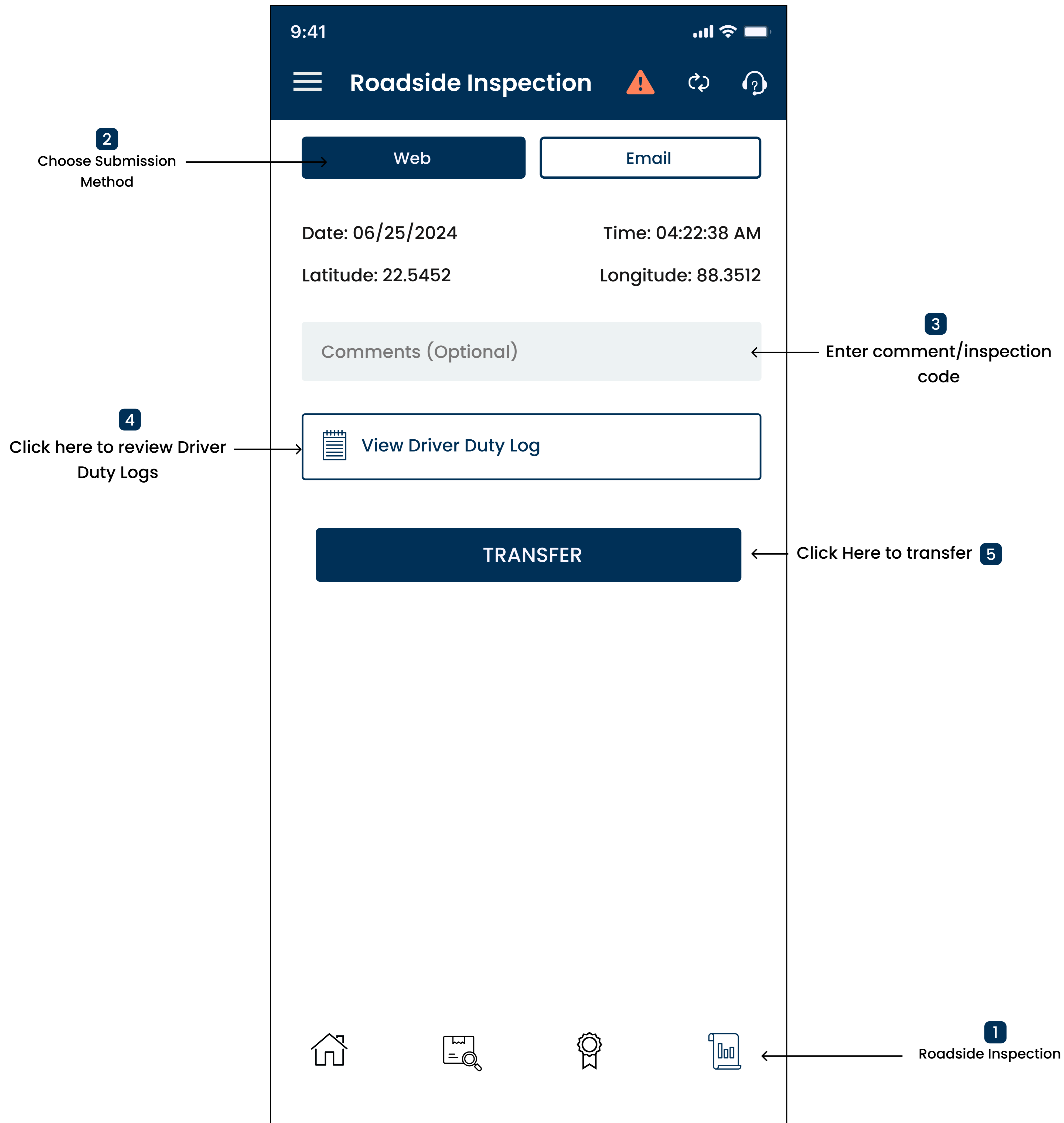

1 Choose Duty Status

2 Write Event Comments

Event Comments

Duty Status: OFF

Event comments must be 4 - 60 characters

CANCEL SAVE

Click Here to save **3**

Choose Duty status & Add Comments

1 View Remaining Hours

Drive Shift Cycle Break

Timers

1 Click Here to view Recap Hours

Recap Hours

2 Recap Hours Summary

Day	Date	Hours Worked	Available Time	Recap Hours
Wed	Oct 13	0	6	-6
Wed	Oct 6	0	70	-11
Thu	Oct 7	0	59	-8
Fri	Oct 8	0	51	-9
Sat	Oct 9	0	42	-10
Sun	Oct 10	0	32	-7
Mon	Oct 11	0	25	-9
Tue	Oct 12	0	16	-10

Recap Hours

In Log Report, you can view 3 Tabs: Header, Chart, and Events.

a. Header:

- View the Current Location, Driver, Co-Driver, Vehicle, ELD, and Carrier details.

b. Chart:

- Displays the Hours Of Service of drivers in a chart view (graphical representation).

c. Event Logs:

- Displays the details of each event, including Event start time, Location, Odometer, Engine Hours, Origin, Event Type/Status, and Event Comments.
- It will display violation-related information if the driver exceeds the duty limitations.
- You can share the Log report by entering the desired email and clicking on send.

Review Driver's Daily Log

a.

RECORD DATE	US DOT #	Driver Licence Number
17-Jun-2024	12345	TESTUSER123
Driver Licence State	ELD ID	Trailer Id
DELAWARE	3B5000132183	T01
Time Zone	Driver Name	Co-Driver Name
GMT+5:30, Asia/Kolkata	User, Test	

b.

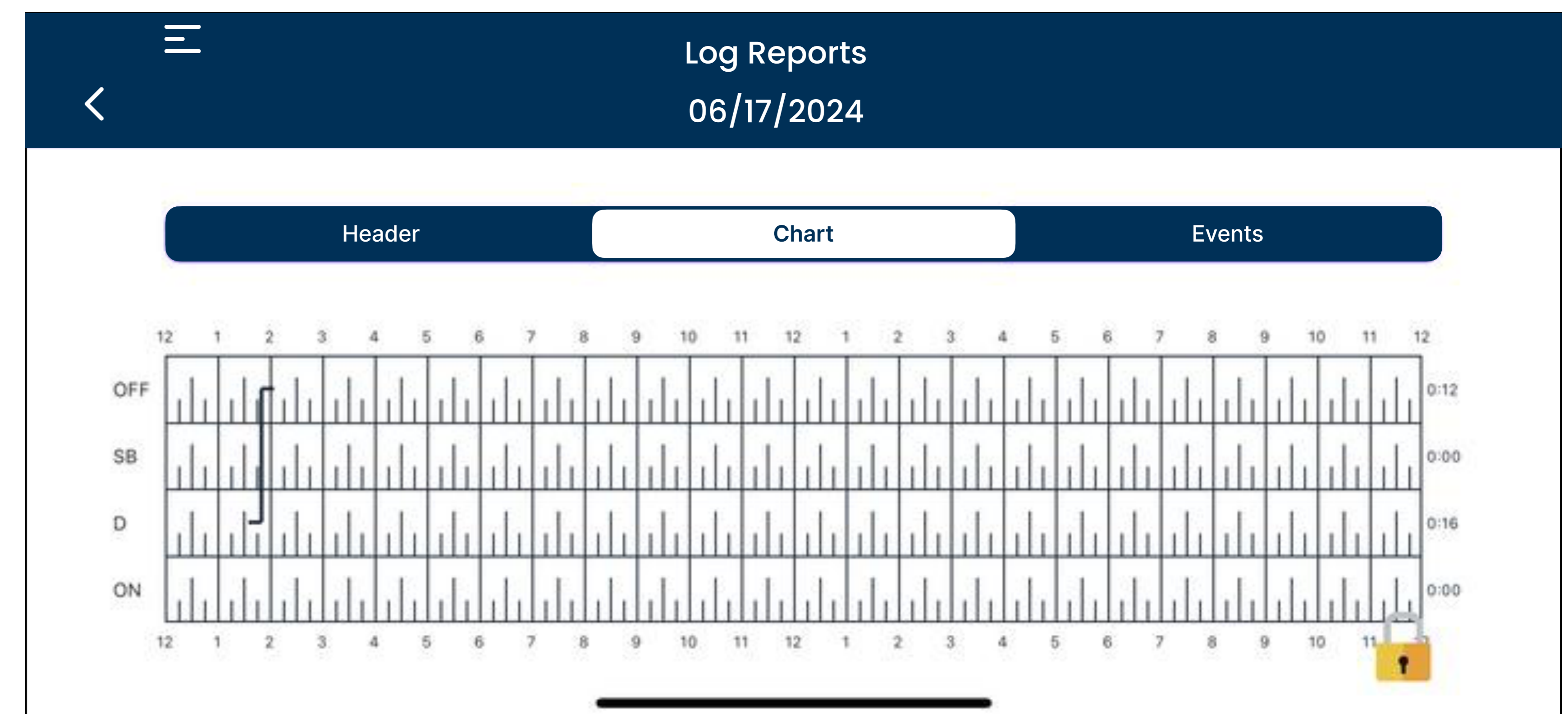

c.

Time	Event	Location	Odometer (Miles)	Eng hrs	Origin
03:35 AM	Driver Login	Location not available	0	0	Manual

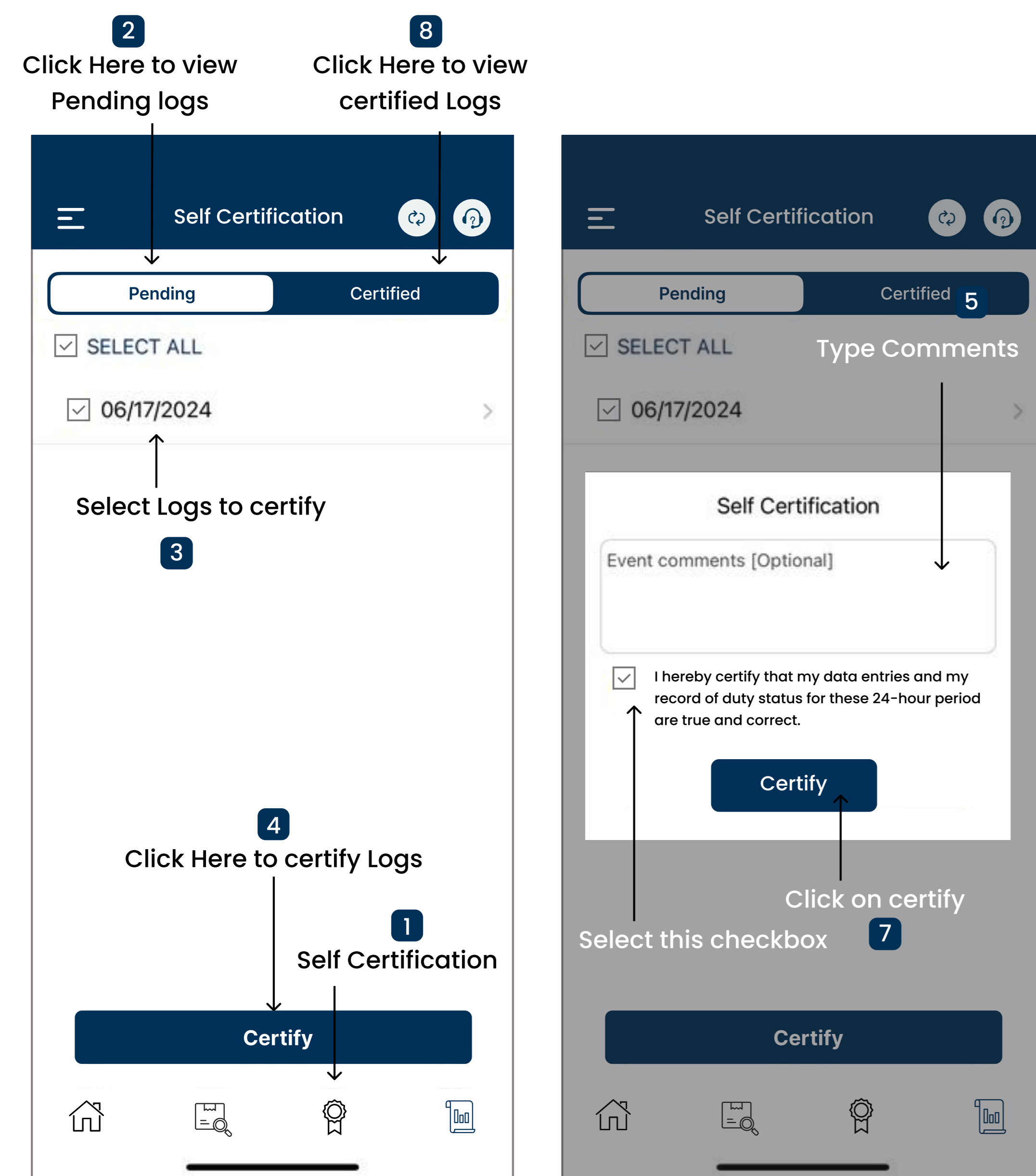

Certify Logs

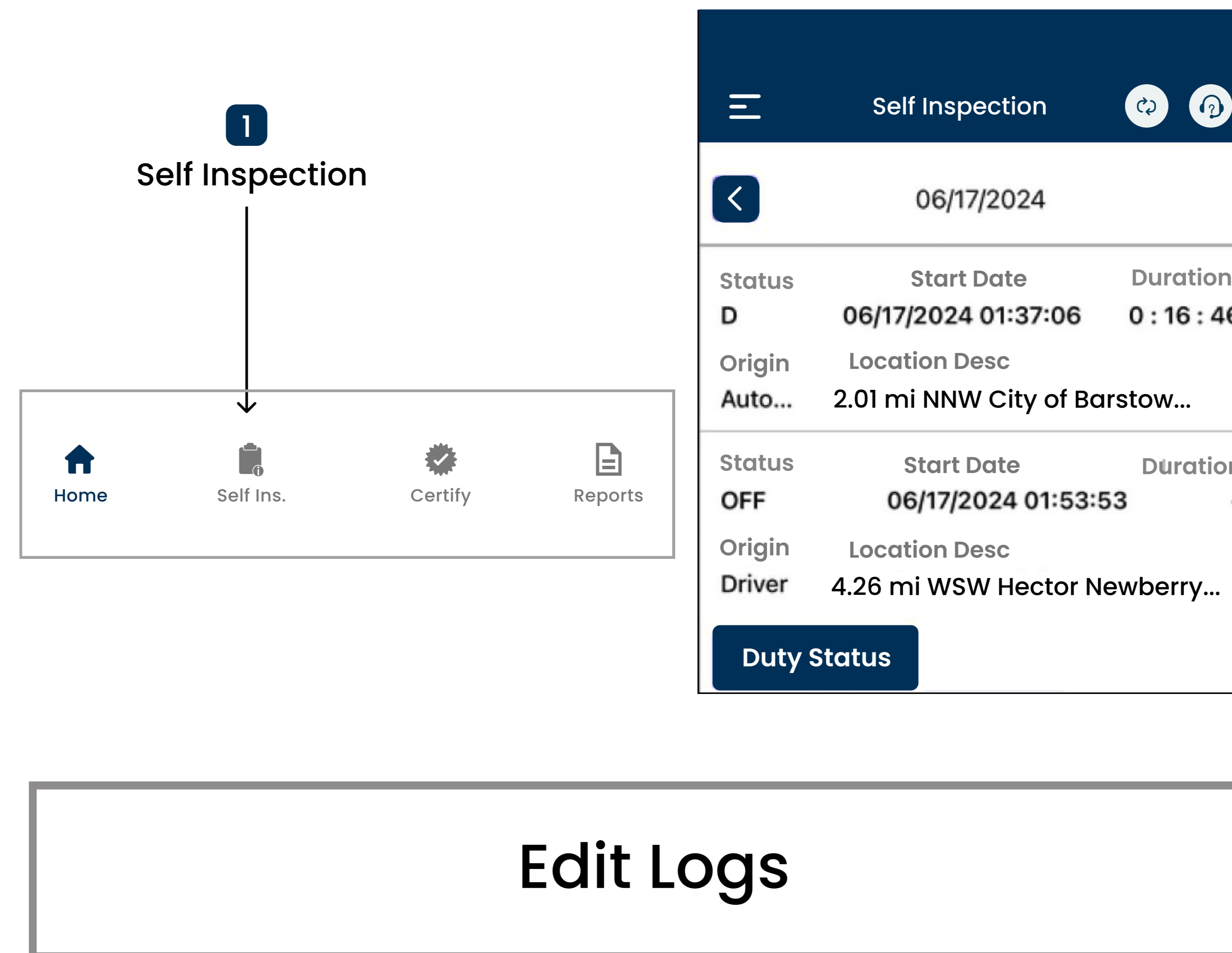

Edit Logs

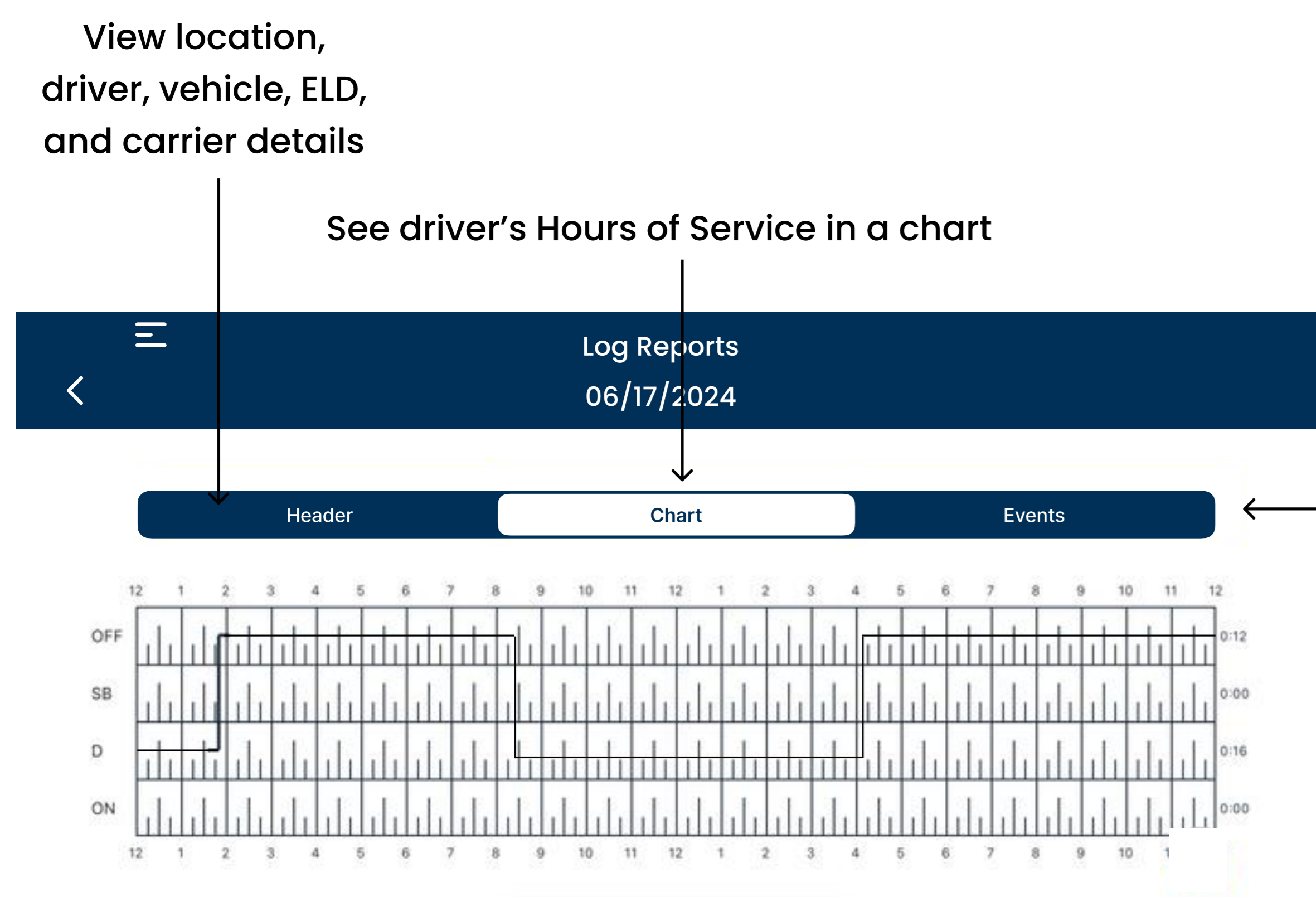

View Log Graph

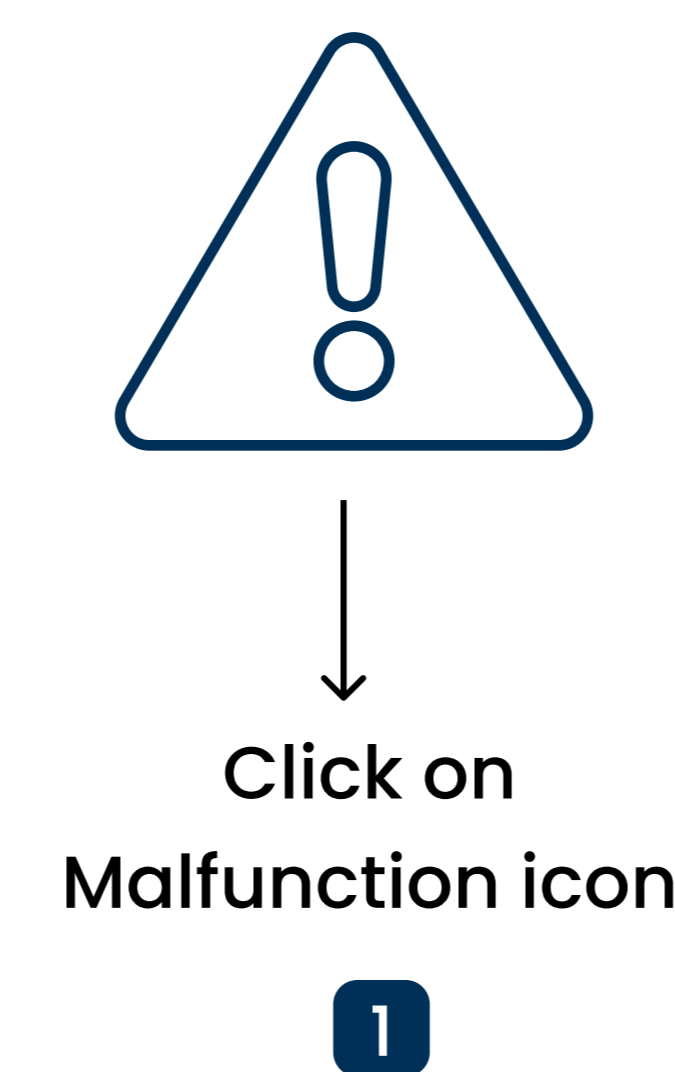

Click on Malfunction icon

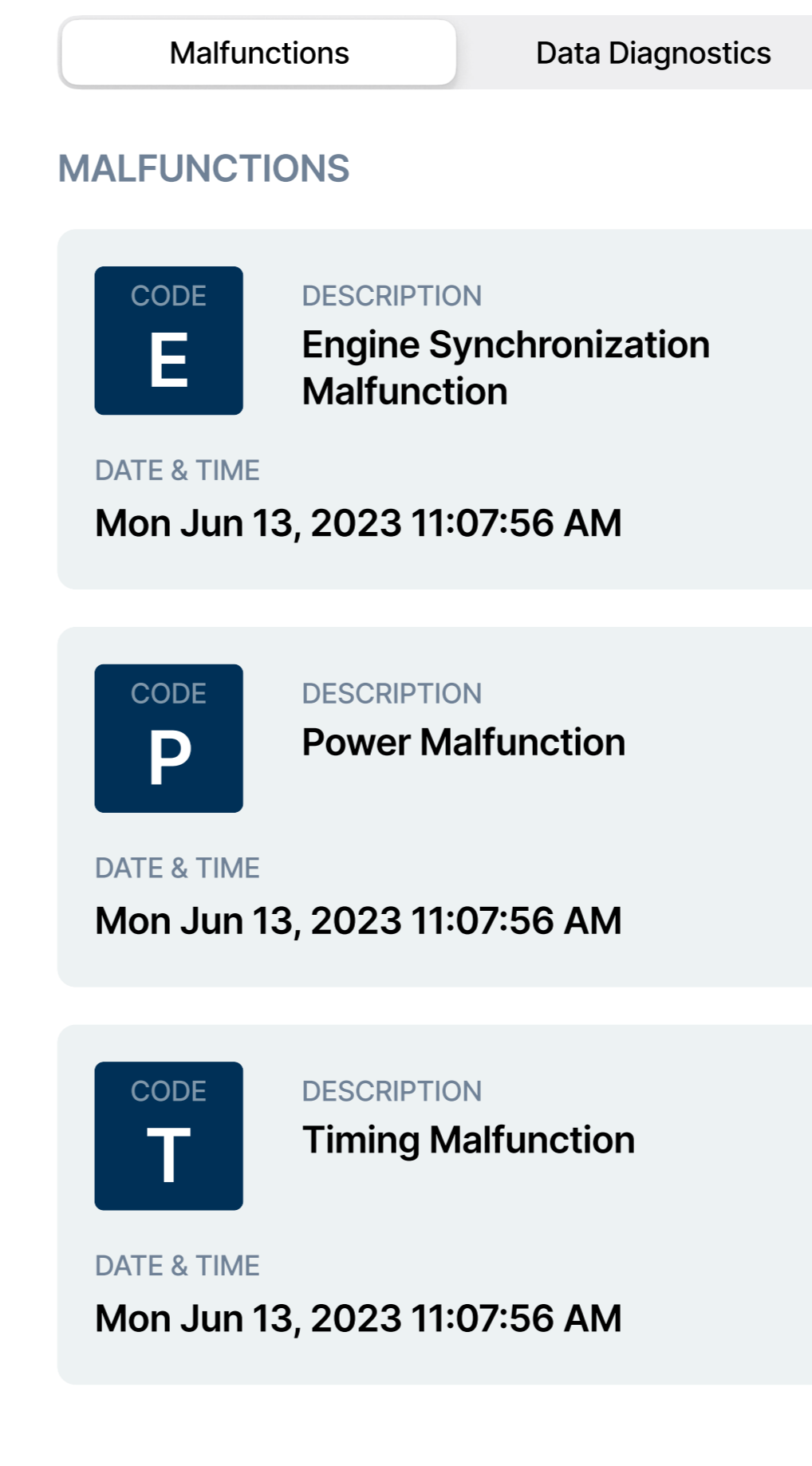

Malfunction & Data Diagnostics

How to report malfunctions and recordkeeping procedures

1. eLogsPlus Prime is capable of monitoring its compliance for various detectable malfunctions. At each instance when an ELD malfunction event is detected or cleared by the eLogsPlus Prime, the ELD records the event. The recorded malfunction events are inconsistencies found while monitoring the ELD against FMCSA compliance requirements.
2. Note the malfunction of the ELD and provide written notice of the malfunction to the motor carrier within 24 hours
3. Reconstruct the record of duty status for the current 24-hour period and the previous 7 consecutive days, and record the records of duty status on graphgrid paper logs
4. Continue to manually prepare a record of duty status until the ELD is serviced and brought back into compliance
5. Compliance Malfunction/ Codes:
 - P "Power compliance" malfunction
 - E "Engine synchronization compliance" malfunction
 - T "Timing compliance" malfunction
 - L "Positioning compliance" malfunction
 - R "Data recording compliance" malfunction
 - S "Data transfer compliance" malfunction
 - O "Other" ELD detected malfunction
 - 1 "Power data diagnostic" event
 - 2 "Engine synchronization data diagnostic" event
 - 3 "Missing required data elements data diagnostic" event
 - 4 "Data transfer data diagnostic" event
 - 5 "Unidentified driving records data diagnostic" event
 - 6 "Other" ELD identified diagnostic event

NAVIGATING KEY FEATURES

1 Click on Load sheet

2 Fill in all the fields

3 Click here to save load sheet

Add Load Sheet

1 Click on DVIR (Ensure you are connected to ELD)

1 Click on this drop down to select Vehicle number

2 Choose a vehicle from the list

3 Click here to save DVIR

DVIR

1 Click on Load sheet

2 Select appropriate exception

3 Click here to save exception

Exception

1 Click on Fuel Purchase

2 Fill in all the fields

3 Click here to save

Fuel Purchase

DAILY DRIVER'S LOG | One Calendar Day 24/hr

Vehicle # :		MM/DD/YY :	
Trailer #(S):		Day's Total Miles:	
Name of Carrier(S):		Drivers Signature:	
Main Office Address:		Name of Co-Driver:	

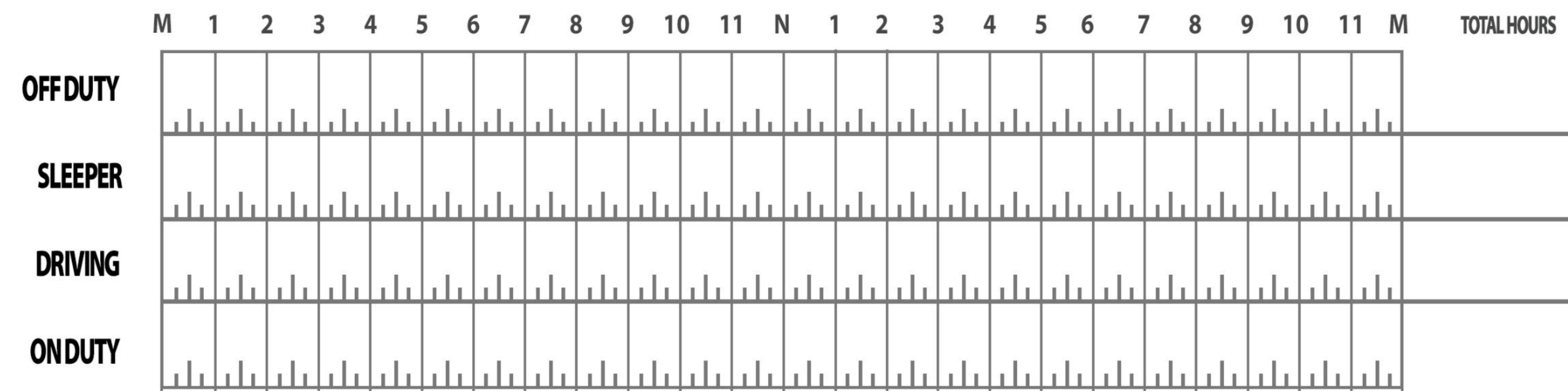

Remarks

Shipping Documents # : _____

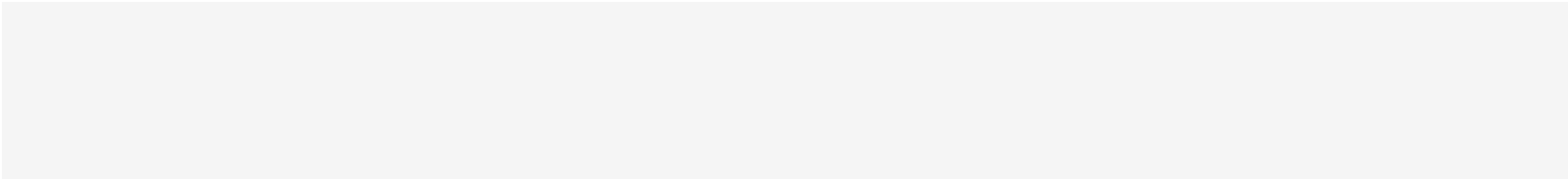

Drivers License #	
Drivers License State	
Drivers ID	
Co-Driver ID	
ELD ID	
ELD Manufacturer	
ELD Malfunction Indicators	
USDOT #	
Time Zone	
24 Starting Time	
Data Diagnostic Indicators	
Start/End Odometer	
Start/End Engine Hours	
Print/Display Date	
Truck Tractor VIN	
Exempt Driver Status	
Unidentified Driver Records	
Current Location	
File Comment	
Time Zone Offset from UTC	